

# GROUP 8: TRANSFER CASE

## 1-Speed Transfer Case

### Rebuilt Early 1-Speed Transfer Case



Vehicle Type: A  
 -Detroit Type  
 Part #CC918337-D  
**Call for Price**  
 -Mechanics Type  
 Part #CC918337-M  
**Call for Price**

### NOS Early 1-Speed Transfer Case & Cover



Vehicle Type: A  
 Part #CC915553  
**\$95**

### Government Rebuilt Late 1-Speed Complete Transfer Case Assembly



Vehicle Type: B  
 Part #CC924413  
**\$450 +**  
**\$100 Core**

### NOS Late 1-Speed Transfer Case & Cover



Vehicle Type: B  
 Part #CC924422 **\$95**

### New Breather Vent

[ORD #A196397]

Vehicle Type: A,B,C,D,E,F,(G,H 1957-68)  
 Replaces Part #CC915564 **\$10**



### NOS 1-Speed Transfer Case Gasket Set



Vehicle Type: A,B  
 Part #CC996418 **\$10**

### NOS 1-Speed Transfer Case Gasket and Seal Kit (4 seals)



For all VC & WC models --  
**Includes:** seal set  
 CC1056077  
 & gasket set  
 CC996418.  
 Vehicle Type: A,B

Part #CC996418-SG **\$32**

### 1-Speed Transfer Case Bearing, Gasket and Seal Set



**Includes:** seal set  
 CC1056077,  
 gasket set  
 CC996418,  
 (6) bearings  
 CC912161 & (6)  
 cups CC698394

Vehicle Type: A,B

Part #BGSS-8-1  
**\$302**

### NOS Mounting Bracket to Crossmember Bolt

(w/cotter pin hole)



3/8" x 1"

Vehicle Type: A,B  
 Part #CC915560 **Set of 4 \$10**

### NOS 1-Speed Transfer Case Companion Flange Seal



Vehicle Type: A,B  
 Part #CC599463 **\$10**

### New 1-Speed Transfer Case Cup & Cone Bearing



Vehicle Type: A,B  
 • Cup (6) required. Part #CC698394 **\$20 ea**  
 • Cone Bearing (6) required. Part #CC912161 **\$33 ea**

### Shifter Shaft Seal



Vehicle Type: ALL (G,H-1957-68 only)  
 New [ORD #500011] Part #CC915561-N **\$7.50**  
 NOS [ORD #500011] Part #CC915561 **\$7.50**

### NOS 1-Speed T-Case Bearing Retainers Input Shaft



Vehicle Type: A,B  
 Part #CC599464 **\$25**

### Front & Rear Drive



Vehicle Type: A,B  
 Part #CC599465 **\$25**

### NOS 1-Speed T-Case Bearing Retainer Studs



-Long Vehicle Type: A,B  
 Part #CC912401 **\$2**  
 -Short Vehicle Type: A,B  
 Part #CC912400 **\$2**

### NOS 1-Speed T-Case Shims



Vehicle Type: A,B (**.007 SOLD OUT**)  
 • .005 Front/Rear Drive Gear Retainer (Replaces .010 CC599474) Part #CC599473 **\$2**  
 • .012 Front/Rear Drive Gear Retainer Part #CC599475 **\$2**  
 • .012 Input Gear Retainer Part #CC599472 **\$2 SOLD OUT**  
 • .005 Input Gear Retainer Part #CC599479 **\$2 SOLD OUT**

## Transfer Case (1-speed)

Typical Exploded Parts View

Most parts in stock for the following Vehicle Types:

- A -1941-42 WWII WC 1/2 ton 4x4 Military Casting #C37832
- B -1942-45 WWII WC 3/4 ton 4x4 Military Casting #C38131

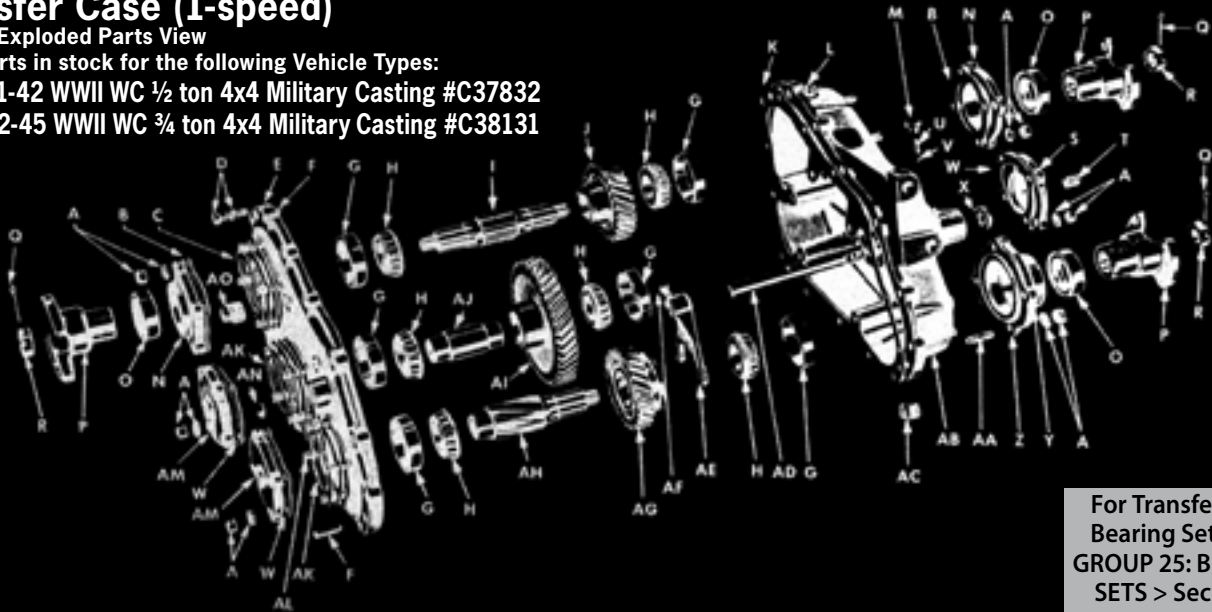

For Transfer Case Bearing Sets, See  
**GROUP 25: BEARING SETS > Section 8**

# GROUP 8: TRANSFER CASE



## NOS 1-Speed Drive Gear

Vehicle Type: A,B  
Part #CC916385 **\$45**



## NOS 1-Speed Idler Gear

•Vehicle Type: A,B  
Part #CC916512 **\$65**

•Vehicle Type: A(VC only)  
Part #CC599456 **\$65**

## NOS 1-Speed Drive Gear Shaft



Vehicle Type: A,B  
Part #CC599458 **\$85**

## NOS 1-Speed T-Case Driven Gear Shaft



Vehicle Type: A,B  
Part #CC599460 **\$75**

## 1-Speed T-Case Flanges (Yokes)

(speedi-sleeve #SSS00162 reqd. on USED)



### Mechanics Type

Vehicle Type: A(except early T-207)  
-USED Part #CC917457-U **\$55**

### Small Detroit Type

Vehicle Type: (A early T-207),



(B-for front & rear, early intermediate)  
-NOS Part #CC599026 **\$85**  
-USED Part #CC599026-U **\$40**

### Large Detroit Type

Vehicle Type: (B late intermediate)



-NOS Part #CC928755 **\$75**  
-USED Part #CC928755-U **\$30**

## New 1-Speed T-Case Flange Speedi-Sleeve

(Repairs Seal Surface on Flange)



Vehicle Type: A,B  
Part #SSS00162 **\$69**

## NOS 1-Speed T-Case Lever Control Rod

Vehicle Type: B



Part #CC924416 **\$25**



## REP T-Case/Transmission Cover Draft Pad

Leather cow hide  
black or brown  
Vehicle Type: B

Rep T-Case Trans Draft Pad w/o winch (No PTO Lever Hole)

-Black Part #CC966650-BK **\$35**

-Brown Part #CC966650-BR **\$35**

Rep T-Case Trans Draft Pad with winch (with PTO Lever Hole)

-Brown Part #CC966622-BR **\$35**

## New 1-Speed T-Case Lever Bushing



ID: 0.750", OD: 0.875"  
Vehicle Type: (A,B except ambulance)

Other variations may exist. Check your dimensions when ordering! (must be cut to length) Part #CC667742 **\$15**

## NOS 1-Speed T-Case Drain Plug



Vehicle Type: A,B  
Part #CC103875 **\$5**

## NOS 1 Speed T-Case Lever Mounting Bracket



Part #CC921863  
**SOLD OUT**

## NOS 1-Speed T-Case Lever Brkt. Spacer



Vehicle Type: B

[ORD #7351127] Part #CC914510 **\$5**



## NOS 1-Speed T-Case Shift Fork

Vehicle Type: A,B  
Part #CC599477 **\$25**



## USED 1-Speed T-Case Mounting Brackets

Specify: Vehicle Type & Right or Left  
Vehicle Type: A,B  
**\$35 each**

## 2-Speed Transfer Case

## Complete Rebuilt 2-Speed Transfer Cases



(Vehicle Type E/F Flanges shown)

•Complete Flat Fender Power Wagon Rebuilt 2-Speed T-Case Vehicle Type: D  
Part #CC1188941 **\$1300 + \$250 Core**

•Complete M37 Rebuilt 2-Speed T-Case Vehicle Type: E,F  
Part #CC1089318 **\$1300 + \$250 Core**

## NOS 2-Speed Transfer Case Gasket Set



[ORD # 7411838]  
Vehicle Type:  
C,D,E,F,(G,H 1957-68)  
(PTO/Plate Gasket  
Not Included)  
Part #CC1057772 **\$12**

## NOS 2-Speed Transfer Case Seal Kit



Vehicle Type: C,D,E,F,(G,H 1957-68)

(6 seals) Part #CC1057773 **\$50**

## NOS 2-Speed Transfer Case Gasket & Seal Kit

Includes: seal set  
CC1057773 & gasket  
set CC1057772.  
(PTO/Plate Gasket  
Not Included)



Vehicle Type: C,D,E,F,(G,H 1957-68)

Part #CC1057773-GSK **\$62**

## New NP200 2-Speed Transfer Case Bearing, Gasket & Seal Set

Vehicle Type: C,D,E,F



Part #BGSS-8-2 **\$310**

## New NP201 2-Speed Transfer Case Bearing, Gasket & Seal Set

Vehicle Type: (G,H 1957-68)



Part #BGSS-8-3 **\$285**

## New 2-Speed Transfer Case Companion Flange Seal



[ORD #7705744]

Vehicle Type: C,D,E,F,(G,H 1957-68)  
Part #CC927637 **\$12.50**

## Shifter Shaft Seal



Vehicle Type: ALL (G,H-1957-68 only)  
New [ORD #500011] Part #CC915561-N **\$7.50**  
NOS [ORD #500011] Part #CC915561 **\$7.50**

## NOS 2-Speed Front Bearing Retainer w/Seal



Vehicle Type: C,D,E,F,(G,H 1957-68)  
[ORD #7342862] Part #CC927389 **\$20**

## NOS NP200 2-Speed T-Case Driven Gear Shaft (1.5 to 1 ratio)



Vehicle Type: C

Part #CC927387 **\$125**



# GROUP 8: TRANSFER CASE



## 2-Speed Driven Gear Shaft

[ORD #7091753]

1.96 to 1 ratio

Very Limited Quantity

Vehicle Type: D,E,F,(G,H 1957-68

Replaces CC1791004 (NP201 Clunker Gear)

NOS 2-Speed Driven Gear Shaft Part #CC1089328 **\$325**

Used 2-Speed Driven Gear Shaft Part #CC1089328-U **\$250**



## NOS 2-Speed Idler Gear

1.96 to 1 ratio

Vehicle Type: D,E,F,(G,H 1957-68)

Part #CC1089324

Very Limited Quantity **\$195**



## USED 2-Speed Drive Gear

[ORD #7412044]

Vehicle Type:

C,D,E,F,(G,H 1957-68)

Part #CC927381-U **\$125**



## NOS 2-Speed Driven Clutch Gear (Input)

Vehicle Type: C,D,E,F

[ORD #7412043]

Part #CC927383 **\$45**

## 2-Speed Front Input Shaft

(Upper) [ORD #7351062] Very Limited Quantity

Vehicle Type: C,D,E,F

Replaces CC1273815

NOS 2-Speed Front Input Shaft Part #CC927385 **\$250**

USED 2-Speed Front Input Shaft Part #CC927385-U **\$175**



## NOS 2-Speed Clutch Gear (Front axle output)

[ORD #7411880]

Vehicle Type: C,D,E,F,(G,H 1957-68)

Part #CC927384 **\$45**

## USED 2-Speed Front Output Shaft

(lower) [ORD #7351134] Very Limited Quantity

Vehicle Type: C,D,E,F

Replaces Part #CC927385

Part #CC1273816 **\$175**



## NOS Bearing Retainer (Rear)

Vehicle Type: C,D,E,F,(G,H 1957-68)

Part #CC927359/CC927360

**\$95**

## USED 2-Speed T-Case Idler Gear Shaft

Vehicle Type: C,D,E,F,(G,H 1957-68)

[ORD #7342505]

Part #CC927361-U **\$150**



## NP200 2 Speed T-Case E-Brake Drum Flange (Yoke)

[ORD #7351116] Vehicle Type: D,E,F

-NOS Part #CC594092 **\$75**

-USED Part #CC594092-U **\$35**

## NOS 2 Speed T-Case E-Brake Drum Flange (Yoke) (6x6)

Small Detroit Type Vehicle Type: C

Also fits D,E,F: Replaces standard E-brake

Drum Flange CC594092 when using

centered rear differential

Part #CC598930 **\$85**

## USED 2 Speed T-Case Front/Rear Axle Flange (Yoke)



Small Detroit Type

Vehicle Type: C,D

Part #CC927680 **\$65**

(speedi-sleeve #SS500212 required)

## NOS 2-Speed T-Case Input Flange (Yoke)



Large Detroit Type

Vehicle Type: D

Replaces CC928721 Part #CC1920602 **\$75**

## M-Series 2-Speed T-Case Input Companion Flange (Yoke)

[ORD #7373704]

Vehicle Type: E,F

NOS Part #CC1268312 **\$75**

USED Part #CC1268312-U **\$30**

(speedi-sleeve #SS500212 required on USED)



## M-Series 2-Speed T-Case Front/Rear Axle Companion Flange (Yoke)

[ORD #7373705] Vehicle Type: E,F

NOS Part #CC1268313 **\$50**

USED Part #CC1268313-U **\$30**

(speedi-sleeve #SS500212 required on USED)



## New NP200/NP201 T-Case Flange Nut Socket (1/2" drive)

For 1 5/16" Nut Vehicle Type: C,D,E,F,G,H

Part #T6DS4 **\$18**

## New 2-Speed T-Case Flange Speedi-Sleeve (Repairs Seal Surface on Flange)



Vehicle Type: C,D,E,F,G,H

Part #SS500212 **\$42**

## New Breather Vent

[ORD #A196397]

Vehicle Type: A,B,C,D,E,F,(G,H 1957-68)

Replaces Part #CC915564 **\$10**

## NOS 2-Speed T-Case Drain Plug



Vehicle Type: C,D,E,F,(G,H 1957-68)

Part #CC103875 **\$5**

## New 2-Speed T-Case Lever Bushing



Vehicle Type: C,D,E,F,(G,H 1957-68)

Cut in half for both levers

[ORD #7342841] Replaces Part #CC926677 **\$15**

## NOS 2-Speed T-Case Shifter Declutch Lever (w/bushing)



[ORD #7351130] Vehicle Type: C,D,E,F,G,H

Part #CC1274209, CC926291 **\$28**

## NOS 2 Speed T-Case Shift Lever Bracket Assembly

[ORD #7372728]

Vehicle Type: (D Late 1956-71),E,F

Part #CC1269515 **\$22**



## NOS 2 Speed T-Case Shift Lever Bracket (w/spacer)

[ORD #7372676]

Vehicle Type: (D Late 1956-71),E,F

Part #CC1272134 **\$10**



## NOS 2-Speed T-Case Lever Lower Bracket Spacer (15/16" length)

Vehicle Type: B

ORD #7351127 Part #CC914510 **\$5**



## USED 2-Speed T-Case Shifter Lever Assembly

Vehicle Type: (D Late 1956-71),E,F

Includes:

Lever Part #CC1274209/CC926291

Lever Part #CC1274207/CC926667

Note: lever CC926667 fits Vehicle Type: G,H

Bracket Part #CC1269515

Washer Part #CC930006

**ONLY SOLD AS AN ASSEMBLY**

Part #2STCSLA **\$75**

## REP T-Case/Transmission Cover Draft Pad (No PTO Lever Hole)



Leather cow hide black or brown

Vehicle Type:

D-1946-(Early)56,C

Part #CC930860 **\$42**

## REP T-Case/NP420 Transmission Cover Draft Pad (No PTO Lever Hole)



Leather cow hide black or brown

Vehicle Type:

D 1956(Late)-71

Part #CC930860-L **\$45**



## NOS M-Series 2-Speed T-Case/ E-Brake Lever Draft Pad w/Retainer

Vehicle Type E,F

Part #CC1278889 **\$45**



## NOS 2-Speed T-Case Drive Shaft Outer Thrust Washer (2 Required)

[ORD#7411881]

Vehicle Type: C,D,E,F

Part #CC927394 **\$6/pair**

## NOS 2-Speed T-Case Drive Gear Shaft Roller Snap Ring (2 Required)



[ORD#7411882]

Vehicle Type: C,D,E,F,G,H

Part #CC862173 **\$5/pair**

## New NP200, NP201, NP205 Transfer Case & NP435 Transmission Poppet Ball Spring



Vehicle Type: C,D,E,F,G,H

Part #CC579195 **\$7.50**

# GROUP 8: TRANSFER CASE



**New 2-Speed T-Case Mounting Bracket Insulator/Lower Rear Motor Mount**  
(8 required) [ORD #7372675]  
Vehicle Type(A-Motor Mount-2 reqd.),D,E,F  
Part #CC1506568, CC593309 **\$10 ea**



**New 2-Speed T-Case Mounting Bracket Insulator Spacer**  
•Vehicle Type: D  
Part #CC1390681 **\$16 ea**  
•Vehicle Type: E,F  
Part #CC1268339 **\$16 ea**



**USED 2-Speed T-Case Mounting Brackets**

Specify: Vehicle Type, Year & Right or Left

**Call For Price & Availability**

**USED 2-Speed T-Case Low Range Control Rod**



[ORD #7373729]

Vehicle Type: E,F  
Part #CC1269517-U **\$25**

**2-Speed T-Case Front Axle Output Control Rod** [ORD #7373730] Vehicle Type: E,F



•USED M37/M43 2-Speed T-Case Front Axle Output Control Rod Part #CC1269519-U **\$25**

**NOS 2-Speed T-Case Low Range Input Shifter Shaft** [ORD #7342858]

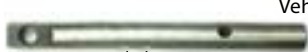

Vehicle Type: C,D,E,F  
5/8" gap -> |--| (center to center)  
Part #CC927379 **\$37.50**

**NOS 2-Speed T-Case Front Axle Output Shifter Shaft** [ORD # 7342859]

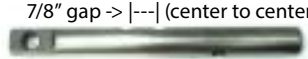

7/8" gap -> |---| (center to center)  
Vehicle Type: C,D,E,F  
Part #CC927380 **\$37.50**

**NOS 2-Speed T-Case Shifter Fork**



[ORD#7091754]  
Vehicle Type: C,D,E,F,G,H  
Part #CC1089319, CC928997 **\$25**

**NOS 2-Speed T-Case Speedo Drive Pinion Retaining Nut** [ORD#7373731]



Vehicle Type: E,F  
Part #CC1268510 **\$18**

**New Speedometer Cable Assembly**



•Vehicle Type: C,D  
Replaces CC1271148  
Part #CC926079 **\$50**  
•Vehicle Type: E,F [ORD #7527479]  
Part #CC1268972 **\$80**

**NOS 2-Speed T-Case Speedo Drive Pinion** [ORD #7373732]



Vehicle Type: E,F  
Part #CC1268670 **\$30**

**NOS 2-Speed T-Case Speedo Drive Gear** (5:83 gear ratio only)



[ORD #7411825]  
Vehicle Type: C,D,E,F,G,H  
Part #CC561651 **\$20**

**NOS 2-Speed T-Case Speedo Drive Gear Spacer**



[ORD #7342499]  
Vehicle Type: C,D,E,F,G,H  
Part #CC927374 **\$15**

**Need Your Transfer Case Rebuilt?**



Our shop offers complete rebuilding services for Dodge Trucks equipped with New Process Transfer Cases

## Transfer Case (2-speed)

Typical Exploded Parts View

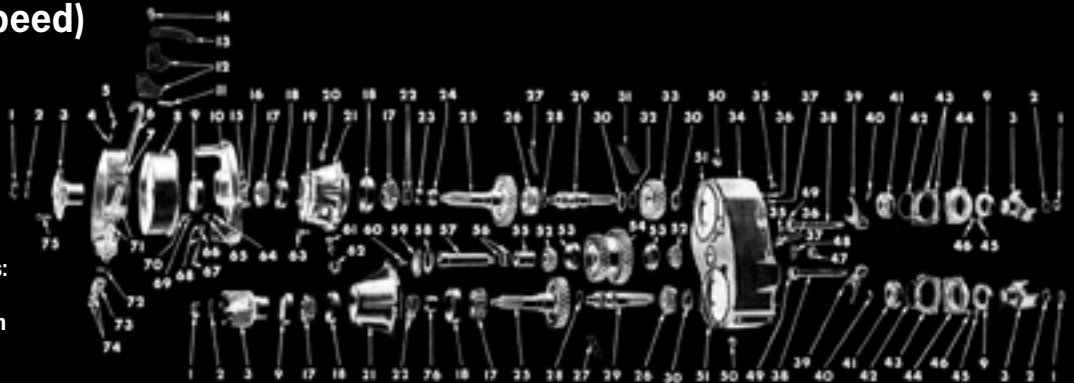

Most parts in stock for Vehicle Types:

- C - 1943-45 WWII WC 1-1/2 Ton 6x6 Military
- D - 1945-71 1-Ton 4x4 Flat Fender Power Wagon
- E - 1951-68 M37, M37B1 & variants 3/4 Ton 4x4 Military
- F - 1951-68 Canadian M37 & variants 3/4 Ton 4x4 Military

For Transfer Case Bearing Sets, See GROUP 25: BEARING SETS > Section 8

| REF. NO. | PART NAME     | PART TYPE CODE | REF. NO. | PART NAME                   | PART TYPE CODE | REF. NO. | PART NAME  | PART TYPE CODE |
|----------|---------------|----------------|----------|-----------------------------|----------------|----------|------------|----------------|
| 1        | NUT           | 15-20-3        | 37       | ROLLER                      | 21-103-19      | 53       | CUP        | 21-104-12      |
| 2        | WASHER        | 15-20-2        | 38       | SNAP RING                   | 21-103-20      | 54       | GEAR ASSY  | 21-104-1       |
| 3        | YOK           | 15-20-1        | 39       | SHAFT                       | 21-103-5       | 55       | SPACER     | 21-104-28      |
| 4        | SPRING        | 4-06-11        | 40       | WASHER                      | 21-103-18      | 56       | SHIM       | 21-104-26      |
| 5        | SCREW         | 4-06-3         | 41       | ROLLER                      | 21-103-25      | 57       | SHAFT      | 21-104-5       |
| 6        | BOLT          | 4-03-1         | 42       | SPACER                      | 21-103-26      | 58       | GASKET     | 21-104-7       |
| 7        | BAND ASSY     | 4-03-1         | 43       | GEAR                        | 21-103-1       | 59       | COVER      | 21-104-6       |
| 8        | DRUM          | 4-01-1         | 44       | CASE ASSY                   | 21-100-1       | 60       | BOLT       | 21-104-6       |
| 9        | OIL SEAL ASSY | 15-20-20       | 45       | SCREW                       | 21-109-13      | 61       | PINION     | 21-85-5        |
| 10       | SUPPORT       | 4-29-1         | 46       | SPRING                      | 21-109-17      | 62       | NUT        | 21-85-40       |
| 11       | COTTER PIN    | 4-26-2         | 47       | BALL                        | 21-109-5       | 63       | BOLT       | 21-103-22      |
| 12       | LEVER         | 4-26-1         | 48       | RAIL                        | 21-109-5       | 64       | LOCKWASHER | 4-29-1         |
| 13       | LINK          | 4-26-11        | 49       | PORK                        | 21-109-1       | 65       | NUT        | 4-29-1         |
| 14       | PIN           | 4-26-2         | 50       | SCREW                       | 21-109-2       | 66       | LOCKWASHER | 4-03-1         |
| 15       | NUT           | 4-26-12        | 51       | BEARING ASSY                | 21-103-7       | 67       | SCREW      | 4-03-1         |
| 16       | STUD          | 4-26-12        | 52       | RING (PART OF BEARING ASSY) | 21-103-7       | 68       | NUT        | 4-03-1         |
| 17       | CONE ASSY     | 21-103-11      | 53       | GASKET                      | 21-102-16      | 69       | NUT        | 4-01-2         |
| 18       | CUP           | 21-103-10      | 54       | RETAINER ASSY               | 21-102-14      | 70       | LOCKWASHER | 4-01-2         |
| 19       | GASKET        | 4-29-2         | 55       | NUT                         | 21-102-14      | 71       | SPRING     | 4-07-4         |
| 20       | NIPPLE        | 21-100-23      | 56       | LOCKWASHER                  | 21-102-14      | 72       | WASHER     | 4-07-5         |
| 21       | RETAINER ASSY | 21-103-22      | 57       | NUT                         | 21-104-33      | 73       | SPRING     | 4-07-5         |
| 22       | SHIM          | 21-103-24      | 58       | WASHER                      | 21-104-33      | 74       | NUT        | 4-07-1         |
| 23       | SPACER        | 21-85-27       | 59       | OIL SEAL ASSY               | 21-109-10      | 75       | BOLT       | 4-01-2         |
| 24       | GEAR          | 21-85-4        | 60       | PLUG                        | 21-100-1       | 76       | SPACER     | 21-103-7       |
| 25       | SHAFT         | 21-103-6       | 61       | GASKET                      | 21-103-23      |          |            |                |
| 26       | GEAR          | 21-111-2       | 62       | CONE ASSY                   | 21-104-13      |          |            |                |