

GROUP 16: SPRINGS, SHOCK ABSORBER

New PW 5/8" Eye Shock Absorbers

Vehicle Type: (D late 1956-71),G,(H front only)



Bushings Included

•Front Part #CC1653453 **\$170 pair**

•Rear Part #CC1653454 **\$170 pair**

New PW 1" Eye Shock Absorbers

Vehicle Type: D 1946-(early)56



Bushings Included

•Front Part #CC1321288 **\$150 pair**

•Rear Part #CC1325974 **\$150 pair**

New M-Series 1" Eye Shock Absorbers



Vehicle Type: E,F

Bushings Included

•Front ORD #7373739 Part #CC1273146-N **\$194 pair**

•Rear ORD #7373740 Part #CC1273147-N **\$202 pair**

NOS M-Series 1" Eye Shock Absorbers



Vehicle Type: E,F

Bushings Included

•Rear ORD #7373740 Part #CC1273147 **\$100 pair**

New 1939-58 2WD 5/8" Eye Shock Absorbers

Bushings Included



Vehicle Type: 1939-58 2WD (1/2 & 3/4 ton)

•Front - overall (extended) length: 17-3/4"

travel length: 6-1/4"

Part #CC596414 **\$85 pair SOLD OUT**

•Rear - overall (extended) length: 19"

travel length: 7-1/2"

Part #CC596419 **\$85 pair CLOSEOUT**

New 1961-78 D/W 100-200 11/16" Eye Front Shock Absorbers



Bushings Included

Vehicle Type: G, D100, D200

overall (extended) length: 23-3/8"

travel length: 9-1/4"

Part #CC2960875 **\$85 pair SOLD OUT**

New 1961-71 D/W100-200 11/16" Eye Rear Overload Shock Absorber



Bushings Included

overall (extended) length: 24-1/8"

travel length: 9"

Vehicle Type: G, D100, D200

Part #CC3420167 **\$150 pair CLOSEOUT**

New Heavy Duty Off-Road 5/8" Eye Shock Absorbers



Vehicle Type: (D late 1956-71),G,(H front only)

•Front overall (extended) length: 18"

travel length: 6-1/4" Part #CC1881895 **\$195 pair**

•Rear overall (extended) length: 20-1/4"

travel length: 7-3/8" Part #CC2240348 **\$195 pair**

NOS Shock Absorber Anchor Stud



Vehicle Type:(D 1946-early 56),E,F

[ORD #7744213] Part #CC1090882

\$18 each



New 3/4"-16 Shock Absorber Nut & Spring Castle Nut

Vehicle Type:(D 1946-early 56 for SHOCK ONLY),(E,F for SPRING & SHOCK)

Part #128180 **\$5**



NOS Rubber 1" Shock Eye Bushing

[ORD #7351084] (4 per shock required)

Vehicle Type: (D 1946-early 56),E,F

Part #CC930048 **\$5**



NOS Rubber 5/8" Shock Eye Bushing

(4 per shock required)

Vehicle Type: D late 1956-71

Part #CC1319902 **\$5**



NOS Shock Absorber Bushing Retainer Washer

Vehicle Type:(D 1946-early 56),E,F

ORD #7378195 Part #CC930050 **\$5**



NOS Rear Spring Frame Mounted Bumper-Curved

[ORD #7349091]

Vehicle Type: B,D,E,F

Mounts on frame above rear springs

Part #CC924161 **SOLD OUT**



NOS Lower Rear Spring Bumper

Vehicle Type: A

Part #CC599097 **\$20**



NOS Front Axle Assembly Bumper

[ORD #7373780] Vehicle Type: E,F

Part #CC1268746 **\$35**



NOS Front Spring Bumper (Frame Mounted Arrestor)

Vehicle Type: E,F

Part #CC1268747 **\$25**

NOS & Rebuilt WWII Knee Action Shocks



Call for Price & Availability

NOS Rear Shock Absorber Link Rod & Eye Bolt Assembly



Vehicle Type: B except ambulance

Part #CC921038 **\$20**

NOS Rear Shock Absorber Link Rod & Eye Bolt Assembly



longer early style Vehicle Type: (T-202 VC only)

Can be cut down and welded to replace

CC915394 & CC921201 for Vehicle Types A,B,C

Part #CC599385 **\$20**

Shock Absorber, Knee Action

Typical Exploded Parts View

Good selection of parts in stock for all models

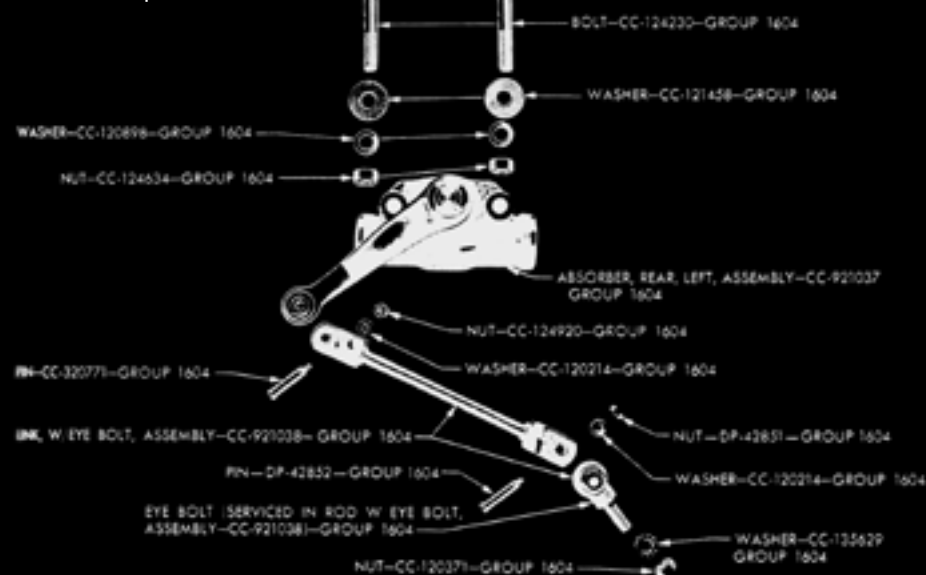

GROUP 16: SPRINGS, SHOCK ABSORBER

New WWII WC 1/2 Ton Front & Rear Leaf Springs

Made in the USA for Vintage Power Wagons & will fit most WC WWII 1/2 Ton vehicles.

New WWII WC 1/2 Ton Front Leaf Spring

Vehicle Type: A (except WC41 & Ambulance)
(8 leaf)



Replaces CC920695
Part #CC914234-N **\$275 Each**

New WWII WC 1/2 Ton Rear Leaf Spring

Vehicle Type: A (except WC41 & Ambulance)
(10 leaf)

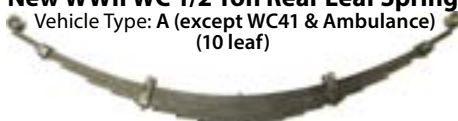

Part #CC599106-N **\$550 Each**

New 1 Ton Flat Fender Power Wagon, WWII WC 3/4 Ton & 1-1/2 Ton 6x6 Leaf Springs

Made in the USA for Vintage Power Wagons and will fit more than just the Civilian Power Wagons.

New 1 Ton Flat Fender Power Wagon, WWII WC 3/4 & 1-1/2 Ton 6x6 Front Leaf Spring

Vehicle Type: B,C,D
(11 leaf)

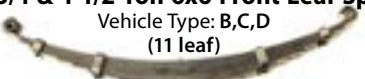

Replaces CC1090570, CC1272998 & more
Part #CC1273201-N **\$365 Each**

New 1 Ton Flat Fender Power Wagon & WWII WC 3/4 Ton Rear Leaf Spring

Vehicle Type: B,D
(12 leaf)



Replaces CC920987, CC1189425, CC1189875 & CC1271367
Part #CC1273003-N **\$585 Each**

NOS WWII WC & Flat Fender Power Wagon Spring Assemblies



• Rear WC-54 Ambulance (wrapped) Vehicle Type: B
Part #CC921477 **\$195 Each**

• Rear WC-62 & WC-63 6x6 Vehicle Type: C
Part #CC926170 **\$195 Each**

• Power Wagon & WC 3/4 Ton Rear Heavy Duty Replacement (Originally WC-64 KD Ambulance Rear Reinforced Spring

- 3-3/4"-overall spring pack, 48"-center eye to center eye, 9"-arc)

Note: may require cutting of 2nd eye wrap for some 3/4 Ton models

Replaces Part #CC920987, CC1189425, CC1189875,

CC1273003, CC1271367 Vehicle Type: B,D

[ORD #7376279] Part #CC1090835 **\$250 Each**

NOS & New M37 & M43 Leaf Springs

Made in the USA for Vintage Power Wagons

NOS M37/M43 Front Leaf Spring

Vehicle Type: E,F
(7 leaf)

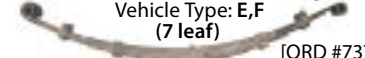

[ORD #7373771]
Part #CC1268098 **\$150 Each**

New M37 & M42 Rear Leaf Spring

Vehicle Type: E,F
(11 leaf)



[ORD #7373761]
Part #CC1268102 **\$450 Each**

New M43 & V41 Rear Leaf Spring

Vehicle Type: E,F
(13 leaf)

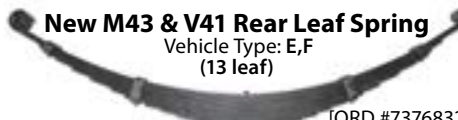

[ORD #7376832]
Part #CC1391099 **\$450 Each**

Rear Springs & Shock Absorbers

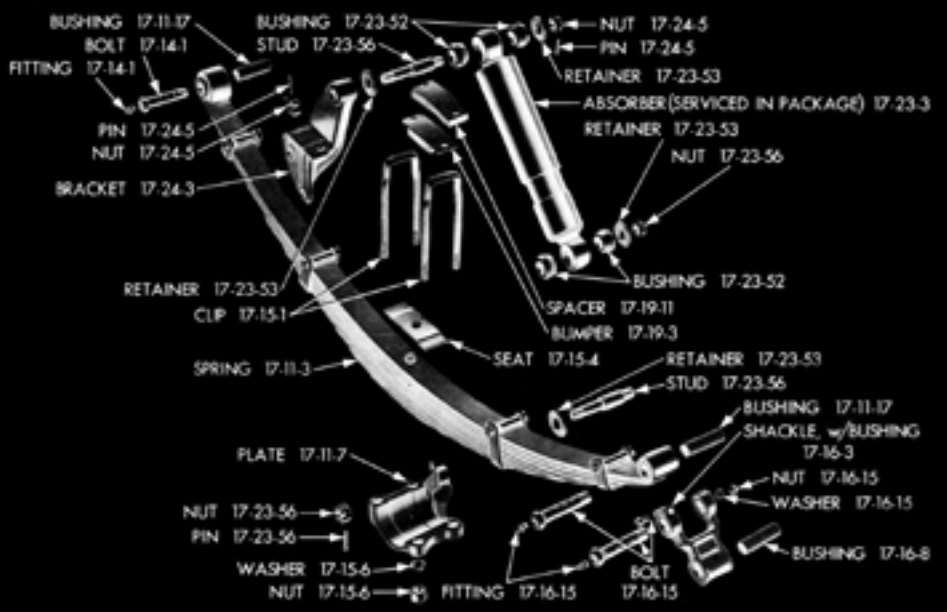

New Rear Spring Repair Kit



NOTE: FOR SOME APPLICATIONS, BUSHINGS MAY NEED TO BE TRIMMED!

Vehicle Type: A Part #KRSR-06 **\$265**

Vehicle Type: B,D Part #KRSR-02 **\$265**

Vehicle Type: E,F (not shown) Part #KRSR-03 **\$220**

New Front Spring Repair Kit

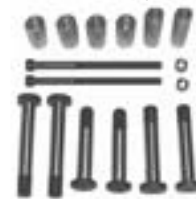

NOTE: FOR SOME APPLICATIONS, BUSHINGS MAY NEED TO BE TRIMMED!

Vehicle Type: A Part #KRSR-05 **\$265**

Vehicle Type: B,C,D Part #KRSF-01 **\$215**

Vehicle Type: E,F (not shown) Part #KRSF-04 **\$278**

Individual parts from kits available on following page

Front Springs & Shock Absorbers

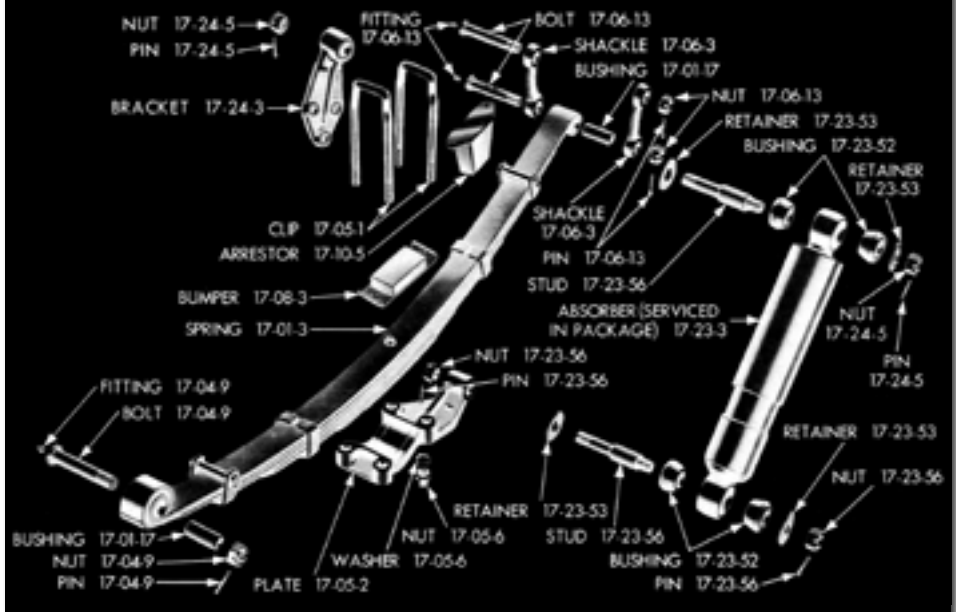

GROUP 16: SPRINGS, SHOCK ABSORBER

NOS M-Series 2" Spring U-Bolt



Vehicle Type: E,F

- Left Front M37 8" x 2" ORD #7376828
Part #CC1192183 **\$20**
- Right Front M37 & M43 8-1/2" x 2"
ORD #7373770 Part #CC1263585 **\$24**
- Left Front M37B1, M43B1 8-1/2" x 2"
ORD #7373770 Part #CC1263585 **\$24**
- Left Front M43 8-1/2" x 2" ORD #7373770
Part #CC1263585 **\$24**
- Rear M37 8-1/2" x 2" ORD #7373770
Part #CC1263585 **\$24**
- Rear M43 9-1/2" x 2" ORD #7376831
Part #CC1263586 **SOLD OUT**

New 1-3/4" Spring U-Bolt



<Rounded inside shoulder

- Front (Left) 8-3/4" x 1-3/4" Vehicle Type: A,B
Replaces CC915648 Part #CC1189909 **\$20**
- Front (Left & Right) 9-1/2" x 1 3/4" Vehicle Type: C,D
Replaces Part #CC916892, CC929345, CC915877
Part #CC599110 **\$25**
- Rear (Left & Right) 9-1/2" x 1-3/4" Vehicle Type: A,B,D
Replaces Part #CC599110, CC916892
Part #CC929345 **\$25**
- 7-1/2" x 1-3/4" (can be used to lighten front spring
pack) Vehicle Type: A,B,D
Part #CC599322 **\$15**

New 9/16"-18 Spring U-Bolt Nut

Vehicle Type: A,B,(C front only),D,E,F, (G 1957-60) Part #CC55481 **\$2**

New 20 Ft Rolls of Poly Slide

use between spring leaves to soften and quiet the ride of your truck. Available in 1-3/4" & 2" wide

- 1 3/4" Vehicle Type: ALL
Part #PS20175 **\$39 DISCONTINUED**
- 2" Part #PS20200 **\$39 CLOSEOUT!**

NOS Rear Spring Shackle



Vehicle Type: A - Ambulance only
Part #CC916240 **\$75**

NOS M-Series Rear Spring Shackle



Vehicle Type: E,F
ORD #7705746 **\$75**

NOS Rear Spring Shackle



3" center to center
some models use longer shackle
Vehicle Type: B,D Part #CC921033 **\$75**

NOS Rear Spring Shackle



4" center to center
Vehicle Type: (D-WDX only),
(B-Ambulance only)
Part #CC925265 **\$75**

NOS Front Spring Shackles



Inner Shackle

- Vehicle Type: E,F [ORD #7373775] Part #CC1268319 **\$7.50**
- Vehicle Type: A,B,C,D Part #CC594261 **\$10**

Outer Shackle

- Vehicle Type: E,F [ORD #7373776] Part #CC1268320 **\$7.50**
- Vehicle Type: A,B,C,D Part #CC594260 **\$10**

New Front Spring Eye Bushing



Vehicle Type: G, D100, D200
Part #CC1920540 **\$24 each SOLD OUT**

New Front Spring Eye & Shackle Bolt

1/2"-20 Thread - 4" (under head) length

Vehicle Type: (G,H multiple applications)
Part #CC1923876 **\$14.50**

NOS 3/8"-24 Rear Spring Center Bolt - 3-7/8"

Vehicle Type: (E,F-M37 & M42 only)
[ORD #7351213] Part #CC532038 **\$2.50**

NOS 3/8"-24 Rear Spring Center Bolt - 4-1/8"

Vehicle Type: A,(E,F-M43 & V41 only)
[ORD #7376830] Part #CC912333 **\$2.50**

New Universal 3/8"-24 Front & Rear Spring Full-Threaded Center Bolt - 6"

[ORD #7351125] Vehicle Type: B,C,D,E,F
CAN BE CUT TO MAKE ANY SPRING CENTER BOLT
Replaces CC588163 Part #CC593805-6 **\$4**

NOS 3/8"-24 Spring Center Bolt - 5"

[ORD #7351125] Vehicle Type: B,C,D
(B,C,D-Front Spring, B,D-Rear Spring.)
Part #CC593805 **\$2.50**

NOS Leaf Spring Center Bolt Nut (3/8"-24)

Vehicle Type: A,B,C,D,E,F
Part #CC120369 **\$0.50**

New WWII WC 1/2 Ton Front & Rear Spring Center Bolt - (5/16"-24 - 6" Length)

Vehicle Type: A-except ambulance
(cut to size) Part #CC593804-6 **\$4**

New WWII WC 1/2 Ton Front & Rear Spring Center Bolt NUT (5/16"-24)

Vehicle Type: A-except ambulance Part #CC120368 **\$1**

New WWII WC & Flat Fender Power Wagon -Front Spring Upper Shackle Bolt

Vehicle Type: A,B,C,D Part #CC594262 **\$25**

New WWII WC & Flat Fender Power Wagon -Front Spring Lower Shackle Bolt

Vehicle Type: A,B,C,D Part #CC594263 **\$25**

New WWII WC & Flat Fender Power Wagon -Front Spring Rear Bolt

Vehicle Type: A,B,C,D Part #CC589539 **\$25**

New WWII WC & Flat Fender Power Wagon -Rear Spring Eye & Shackle Bolt

Vehicle Type: A,B,D Part #CC590419 **\$32**

New WWII WC & Flat Fender Power Wagon -5/8"-18 Front Spring Castle Nut

Vehicle Type: A,B,C,D Part #CC125267 **\$5**

New WWII WC & Flat Fender Power Wagon -Front Spring Eye Bushing

Vehicle Type: A,B,C,D
Replaces CC548104 Part #CC564263 **\$15**

New WWII WC & Flat Fender Power Wagon -Front Spring Frame Bracket Bushing

Vehicle Type: A,B,C,D
Part #CC594254 **\$21**

New WWII WC, Flat Fender Power Wagon & M37 -Front & Rear Spring Eye Bushing

Vehicle Type: (A,B,D-rear only),(E,F front & Rear)
(Replaces CC512289 on M37) Part #CC576042 **\$15**

New WWII WC, Flat Fender Power Wagon & M37 -Rear Spring Shackle Bushing

Vehicle Type: A,B,C,D,E,F
(Replaces CC562302 on M37) Part #CC576030 **\$15**

New M37, M43 & Variants

-Front Spring Rear Shackle Frame Bushing
Vehicle Type: E,F Part #CC562296 **\$15**

New M37, M43 & Variants

-Front Spring Lower Shackle Bolt

Vehicle Type: E,F
[ORD #7373778] Part #CC1268322 **\$32**

New M37, M43 & Variants

-Front Spring Front Eye Bolt & -Upper Shackle Bolt

Vehicle Type: E,F
[ORD #7373777] Part #CC1268321 **\$32**

New M37, M43 & Variants

-Hex Head Rear Spring Eye & Shackle Bolt

Vehicle Type: E,F Part #CC1268357 **\$24**

New M37, M43 & Variants -3/4"-16 Spring Castle Nut

Vehicle Type: E,F Part #128180 **\$5**

New Grease Zerk Fittings

Vehicle Type: ALL
Specify: Straight, 45° or 90°
Specify: Straight, 45° or 90°
Part #NGZF-(specify size & angle) **\$1.50 ea**

NOS Rear Torque Link Assembly

(6 Required) Vehicle Type: C
Part #CC928908 **\$75**

NOS Torque Link Bushing & Ball Stud Repair Kit

Vehicle Type: C
(8 Required)
Part #CC928912 **\$20 each**

NOS Torque Link Frame Bracket

(2 required)
Vehicle Type: C
Part #CC928262 **\$50**